



Visit our website for all your launcher dummies and launcher accessories for your Sport Grouse PRO Remote Launcher.

[www.sportingsaint.co.uk](http://www.sportingsaint.co.uk)



Join us on Facebook

**SPORTING SAINT—GUNDOG TRAINING EQUIPMENT**



Follow us on Twitter

**@SPORTINGSAINT**



See us on YouTube

**SPORTING SAINT—GUNDOG TRAINING EQUIPMENT**



We're also on Instagram

**SPORTING SAINT**



## Sport GrousePRO REMOTE CONTROL LAUNCHER INSTRUCTION MANUAL

## SAFETY FIRST

This device fires a dummy at considerable velocity. It is capable of causing severe injury or death to any person, animal or object it may hit if used incorrectly. Treat the launcher as you would a loaded gun. Never point it at anyone or anything under any circumstances. Always leave it unloaded when not being used.

## ALWAYS

- **WEAR BOTH EAR AND EYE PROTECTION WHEN USING ANY LAUNCHER!**
- Make sure the launcher dummies intended trajectory is clear of obstacles, property and wildlife.
- The launcher has been set up in a stable way and is not likely to be knocked over or fall.
- Use only **.22 calibre launcher blanks** of either low or medium power.
- Never leave the launcher unattended where a person or animal may wander into its path or collide or interfere with it.
- Use only the correct type of launcher dummy
- Make sure any launcher dummy is in good working condition.
- Keep the launcher clean and well maintained.
- Make sure that there is no other source of radio signal that may inadvertently fire the launcher. Keep the remote with the operator at all times. It may operate the launcher from a considerable distance so never be around a launcher if someone else has the handset/controller.
- Remember wind may affect the dummies intended trajectory so be sure you have allowed plenty of space for the dummy to land safely.
- Without a dummy in place the launcher will fire out a hot flash/flame this is capable of damaging anything it makes contact with and may also be a fire hazard.
- **Never fire the launcher without a blank in with the head unit closed**, it will cause damage to the firing pin/extractor mechanism.

## FREQUENTLY ASKED QUESTIONS

### **How far away will the remote handset work to FIRE the remote launcher?**

The remote handset will comfortably work up to 400m.

### **If I want to purchase additional launchers in the future to add to my Sport Grouse PRO is this possible?**

Yes we supply a 4 button remote handset which means you can program up to 4 remote launcher to the one handset, follow steps on page 9 on how to tune the new launchers to your original remote handset.

### **Do I get any warranty with my Sport Grouse PRO?**

Yes you get a 1 year warranty with remote launcher read page 12 for more information.

### **I have tried all trouble shooting methods and launcher is still not working, what do I do?**

Please contact us either via email or telephone to advise you are having problems and have followed all troubleshooting methods with no success. We can arrange for you to return the unit for our technical department to diagnose the fault.

### **How do I return the launcher to you if I need to?**

If you need to return your remote launcher back to us, ensure you contact us first so we are aware that the launcher is being returned back. Pack the launcher well in a sturdy box with your full contact details and the problem with the launcher to make sure it is not damaged in transit. Use a courier service with a proof of delivery.

Contact Tel 01885 400343

Email [info@sportingsaint.co.uk](mailto:info@sportingsaint.co.uk)

Return Address:

Sporting Saint Ltd

Lower Winslow Farm

Bromyard

Herefordshire

HR7 4SE

## FREQUENTLY ASKED QUESTIONS

### **My Launcher Dummy is travelling too far?**

Generally PVC launcher dummies will travel further than Canvas, if you are wanting to reduce distance use a lower level blank or try a streamer launcher dummy.

### **My Launcher Dummy is loose on the launcher head?**

Try changing the o ring on the end of the launcher head as they will deteriorate over time and the seal will reduce. Check and replace regularly.

### **I have pressed the ON/OFF rocker switch to ON but LED light is not lit up?**

Try charging the unit as it sounds as though they are low, follows steps on page 6 to charge the unit.

### **My Launcher is turned on and clicking, when trying to launch its not firing?**

This generally means the batteries need charging, there is not enough power to push the cocking lever to fire. See page 6 on how to charge your launcher

### **My Launcher is turned on but when I press Launch button on handset nothing happens?**

Ensure remote handset is turned on, follow steps on page 9 to retune your remote handset to your launcher.

### **When I press the Launch button on my remote handset, the green light does not flash?**

Ensure remote handset is turned on, If it is then replace the battery at the back of the remote with a PP3 battery as originally supplied.

## SETTING UP

Make sure the ground the launcher is to fire from is suitable. Never fire the launcher on over firm ground such as concrete, tarmac or stone surface, or even very hard earth as damage to the launcher can be caused by the recoil.

The lower leg sections are drilled with two holes, to allow use of metal pegs to aid extra stability if required.

## LOADING

Once you are happy with the launchers position then loading can begin (a very small spray of lubricating oil e.g. Sporting Saint Dummy Launcher Lubricant Spray onto the launcher seal will assist loading and the launching operation).

1. Slide on your launcher dummy onto the spigot.
2. Open the head section by pressing the release lever and b) insert a blank into the chamber.
3. Close the head section gently, making sure the latch is fully engaged.
4. Turn on the launchers main switch so you can see red in the plastic window and the green LED will illuminate.
5. Cock the launcher by pulling the cocking lever back and into the LH J slot. Remember if the cocking rod is released for any reason when pulling back as the launcher will fire so make sure you are clear of the dummy, wearing ear and eye protection.
6. To fire - turn on the handset switch, press the corresponding button on the handset that operates the launcher. The solenoid will release the cocking lever and the launcher will fire.
7. Open the head section and pull it back slightly to operate the extractor to lift the blank. Remove the blank.
8. Shut the head section and begin procedure again.
9. Once you have finished, ensure the launcher is **TURNED OFF** to preserve the battery life.

Slide on your Launcher Dummy

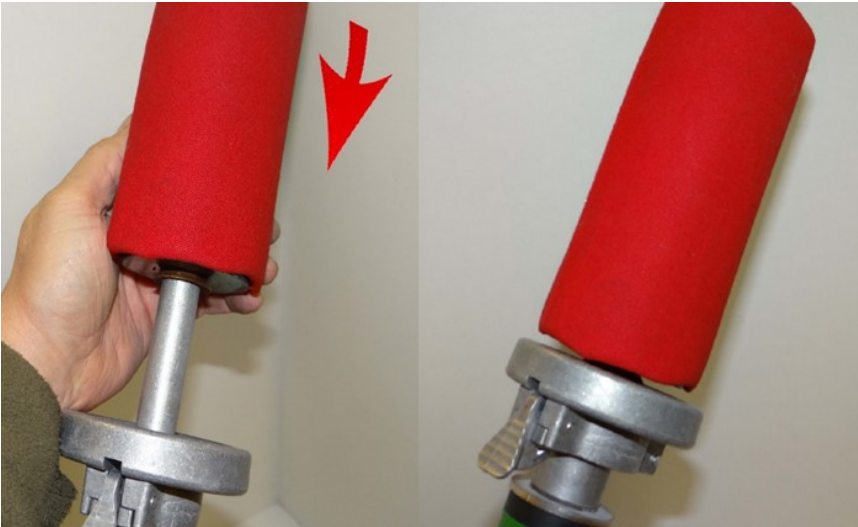

Open the Launcher Head Section

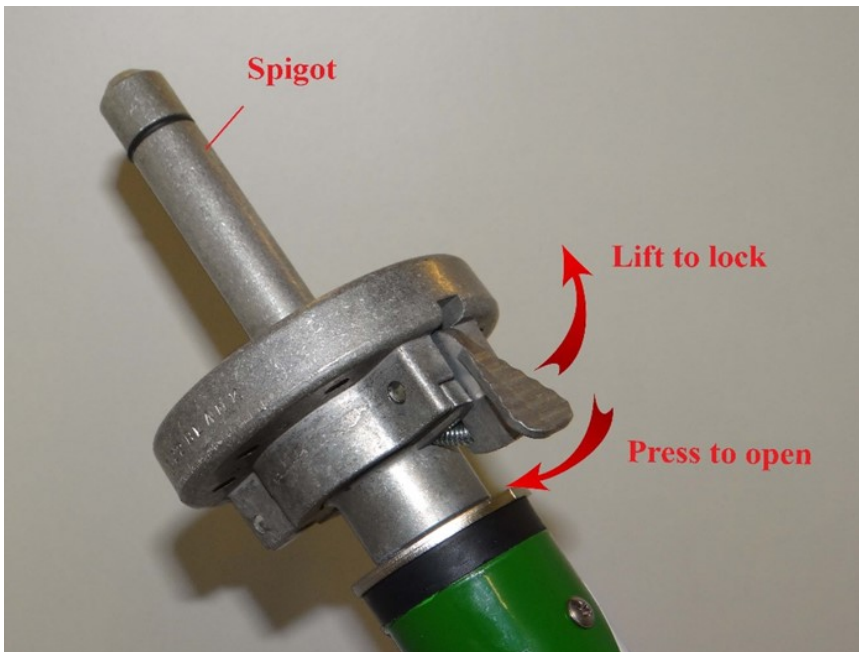

## WARRANTY

Sporting Saint Remote Launcher products are covered by a 1 year return to base warranty as laid out below;

- Proof of purchase must be retained to validate warranty. Due to the nature of use no warranty is implied or given on dummies or blanks.
- A 1 year return to base from date of purchase parts and labour warranty applies to any launcher that meets the criteria as set out below.
- Any product that requires repair within the first three months of purchase shall be collected from the customer with Sporting Saint paying the cost of the courier service chosen by Sporting Saint. No cost for packaging/service is included only the courier service charge booked by Sporting Saint.
- After three months the customer is responsible for the return cost back to Sporting Saint by whatever service they choose. Sporting Saint will pay the return to customer courier charges until a period of 1 year from date of purchase has lapsed.
- The launchers are covered for all mechanical and structural faults for a maximum 1 year period only.
- The launcher warranty is not applicable for launchers used in a commercial environment. This being considered, scurries or working test, professional trainers or kennels, training groups and clubs unless otherwise specified.
- The launcher has to have been properly maintained, with no modifications or otherwise or signs of abuse or misuse.
- Batteries are not covered under any circumstances.
- Launchers found to have used the Red or over powered blanks, humane blanks or similar are exempt from cover immediately
- After 1 year the customer is liable for both parts and labour on any repairs as well as shipping to and from Sporting Saint
- This warranty is not transferable and only applies to the original purchasing customer.

## MAINTENANCE

The launchers are water resistant but not waterproof. Do not use them in very wet conditions. Light rain may be tolerated for a short period.

Never store a dummy on the launchers spigot as it will seize onto the spigot.

Always store the launcher in somewhere warm and dry if it has been used in moist conditions ensure it dries fully before storing.

Periodically open the launcher head and without a blank in cock the launcher then Spray a very small quantity of Sporting Saint Dummy Launcher Lubricant Spray down the firing pin hole. **Never spray oil down the hole the blank goes in.** This will cause misfires. Clean the .22 chamber every so often with a .22 cleaning brush.

Available in The Sporting Saint Dummy Launcher Care Pack.

Keep the spigot clean at all times, wipe with a baby wipe or similar to remove burn powder residue. Change the seal if it looks perished or worn as this will greatly affect dummy launching distance.

Check the launcher out before every use. If something seems wrong or loose refrain from using the launcher until the problem is addressed.

Insert Blank, Close the Launcher Head Section

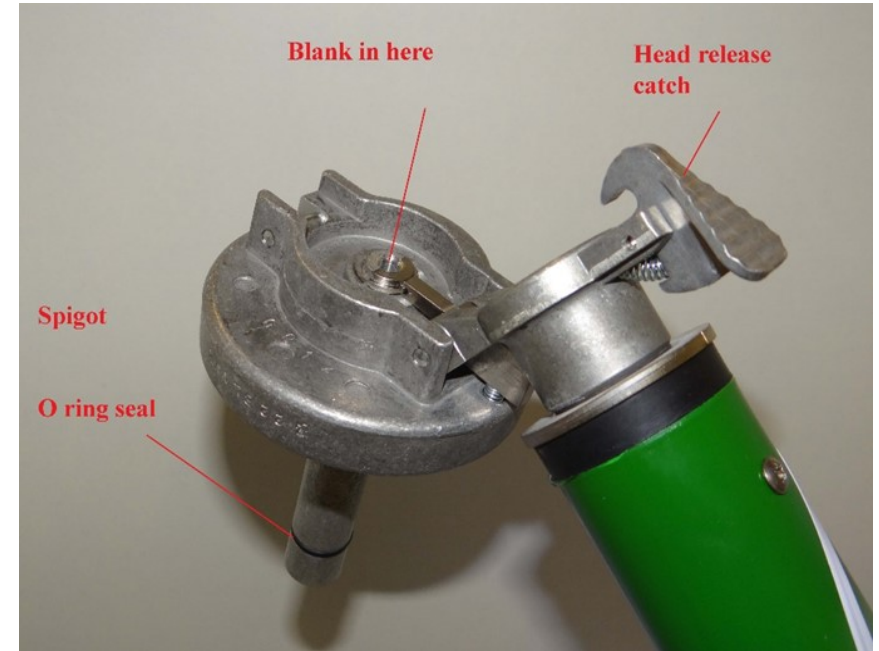

Turn on the Launchers main switch

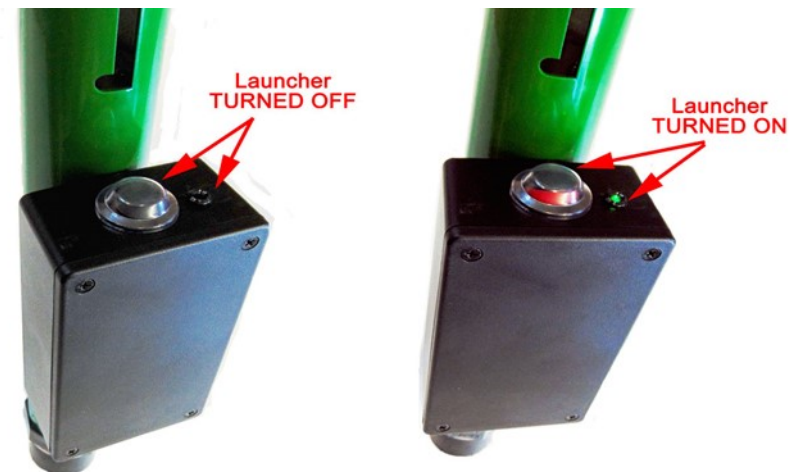

Cock the Launcher by pulling the cocking lever back

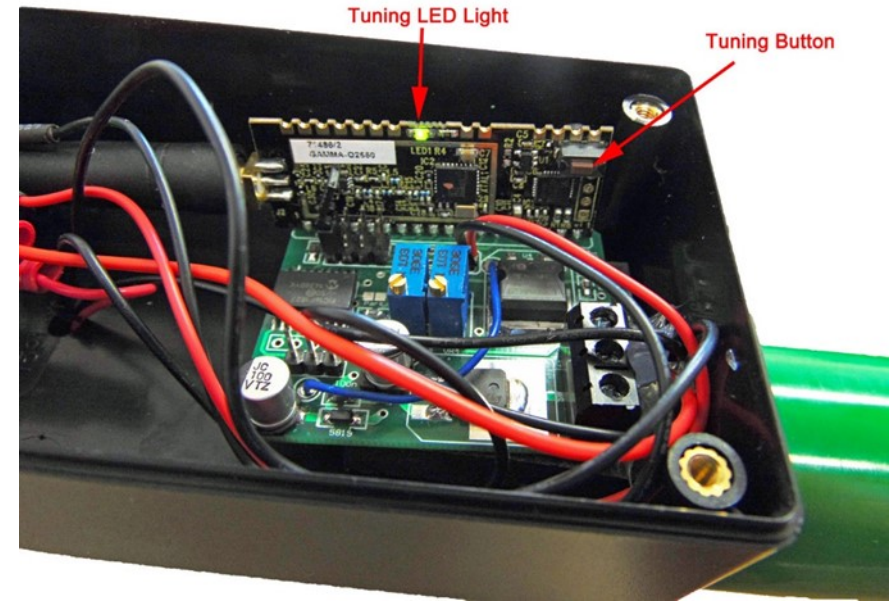

To fire turn on remote handset and press the appropriate launch button.



## TUNING REMOTE HANDSET TO REMOTE LAUNCHER

The Sport Grouse PRO launcher will come tuned in with your remote handset, however if you are purchasing an add on grouse or if your batteries run dead/completely flat you may have to tune/pair the remote handset to the your remote launcher. You will require a phillips head screwdriver.

1. Ensure the launcher is turned on. The rocker switch is red and the green LED is illuminated.
2. Undo the screws on the black box situated on the outside of the launcher body tube and undo the screws on the back of the remote handset.
3. Remove the lids from both the launcher and handset carefully to view the electronic board.
4. Located at the bottom of the launcher board is a program/tuning black button see images below. Press program/tuning button on the launcher board until green light flashes.
5. Wait 2 seconds then press several times the program/tuning button on the back of the remote handset, a green light will flash on the electronic board.
6. Press and hold the button on the remote handset you would like to program/tune launcher on, a LED green light will light on front of remote handset. When LED stops flashing your launcher should be paired with the remote handset.
7. Replace the lids and screws onto both the launcher box and the remote handset, and secure tightly.

See images over the next page to guide you with step by step process with tuning/ pairing your remote launcher.

## CHARGING THE LAUNCHER

The Sport Grouse PRO launcher is powered by 9.6V 2500mAh AA NiMH Square (2x2x2) Transmitter RC Battery Pack which a rechargeable low self discharge battery.

What is "Low-Self-Discharge" technology?

The term low self discharge means that the battery will not run down after being charged anything like as fast as a conventional NiMH or NiCd rechargeable battery would. After being charged, these batteries will typically retain 80% of that charge after 6 months, and 70% after 12 months, ideal for Sport GrousePRO where they receive occasional use, basically after being left for a couple of months you can just pick up where you left off.

To charge, simply locate the DC female mount charging socket on the side of the black box on the launcher body. Insert the charger's DC male power plug.

The charger supplied with your launcher is a Smart Charger, which can distinguish 4~10 cells pack by MPU inside Automatically and cut-off the charging accordingly. It is easy to use with a LED lito easily identify the current charging status.

The status LED will glow Red when the batteries are receiving charge. After charge is completed, the status LED will change green to indicate that the charge is completed and batteries are ready for use. Once the status LED is Green, the charge switches to trickle mode to keep the batteries at full.

### Important Safety Instructions

This charger is intended for use with only the Sport GrousePRO's rechargeable batteries only. Attempting to charge other types of batteries may cause personal injury and damage to the charger.

Do not expose charger to rain or moisture. For indoor use only.

Remove from mains when not in use.

Never use an extension cord or any attachment not recommended by manufacturer, otherwise this may result in a risk of fire, electric shock or injury to persons.

Do not operate the charger if it has been subjected to shock or damage.

Do not disassemble the charger. Incorrect reassembly may result in a risk of electric shock or fire.



DC Female  
Power Plug

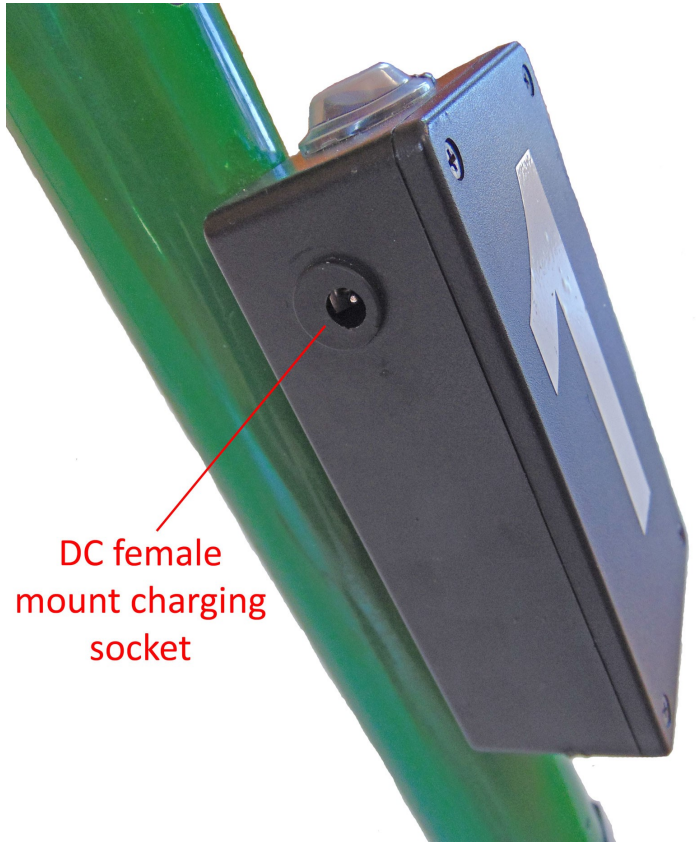

DC female  
mount charging  
socket

Charger fitted to Sport GrousePRO ready to be charged.  
The status LED will glow red when the batteries are receiving charge. And turn green once charge is complete.

